

Study Abroad at La Trobe

Australia 2019



LA TROBE
UNIVERSITY • AUSTRALIA

All kinds of clever

Welcome to La Trobe

Study at a modern and vibrant university in one of the world's most liveable cities.

Founded in 1967, La Trobe's dedicated teachers and world-class facilities continue to produce independent thinkers and highly competent professionals across all walks of life.

Located north of the city centre, our Melbourne Campus is set among extensive parkland, waterways and a native wildlife reserve home to emus, kangaroos and koalas.

You can follow your passion with a choice of more than 2 000 subjects and enjoy the many activities available on campus. Once you're done with study, take a tram to the city, or team up with new friends and escape into Victoria's beautiful surrounds.

CHOOSE FROM MORE THAN
2 000 SUBJECTS

WE'RE IN THE
TOP 1.5%
OF 27 000 UNIVERSITIES
WORLDWIDE¹

WE'RE RATED
**WELL ABOVE WORLD
STANDARD**
IN 19 FIELDS OF RESEARCH

LA TROBE IS THE FIRST UNIVERSITY
IN AUSTRALIA TO RECEIVE A

**SIX-STAR
SUSTAINABILITY
RATING**

CHOOSE TO STUDY AT OUR
MELBOURNE
OR
BENDIGO
CAMPUSES

1. QS World University Rankings 2019;
Webometrics Ranking Web of Universities 2018



Life in Melbourne



Melbourne has ranked consistently as one of the world's most liveable cities. It's also ranked in the top three student cities worldwide.*

Your city of culture

From Melbourne's hidden laneways to its distinctive surrounding suburbs, you'll never want for cool cafés, pubs, bars, galleries, festivals, shopping and sport.

During your stay, you might catch the Melbourne International Comedy Festival, Melbourne International Film Festival, Melbourne Fashion Week, Melbourne Writers Festival, Melbourne Fringe, various music festivals and street parties, or the all-night, city-wide White Night, where Melbourne comes to life in a blaze of colour.

A city for all tastes

Melbourne enjoys a well-earned reputation for outstanding food and coffee.

You'll find a variety of authentic, affordable and delicious options at Melbourne's many Vietnamese, Chinese, Greek, Italian and Indian restaurants and eateries. If you want Ethiopian, Korean, or a steak night at the local pub, we've got that too.

For indulgent weekend mornings, find a café and nestle in with breakfast, friends and the newspaper. If you like to eat, you won't leave disappointed.

Australia's sporting capital

Melbourne is the sporting capital of Australia and plays host to an impressive range of sporting events.

Attempt to understand a game of international cricket, Australian Football or rugby; hold onto your hat at the Formula 1 or the Spring Racing Carnival; grab a seat at the Australian Open, or head down to Bells Beach for the Rip Curl Pro surfing competition.

Getting around Melbourne is easy with our extensive network of trains, trams, buses and bicycle paths.



Princes Bridge and the Yarra River.



Laneways in the heart of the city.

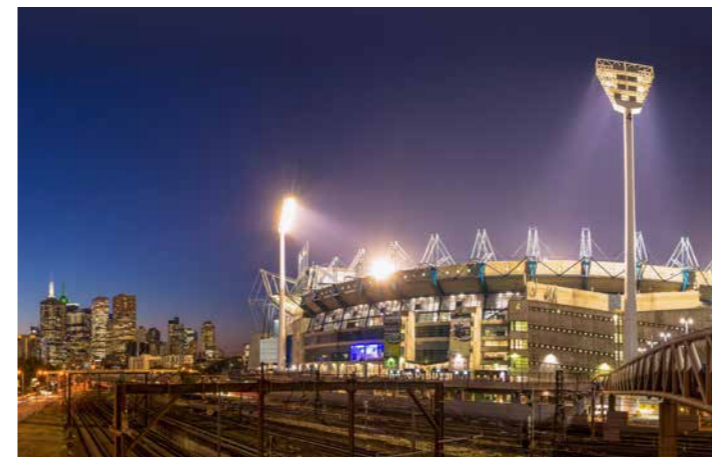

Friday night game at the Melbourne Cricket Ground.



The Royal Exhibition Building in Carlton Gardens.

* educoglobal.com/2018-best-student-cities-melbourne-and-sydney-in-worlds-top-10/

The State of Victoria



Away from the cities, Victoria has a wealth of attractions for nature lovers.

Victoria's size makes it easy to explore. Rent a car, catch a train or book a tour to see the Great Ocean Road, Phillip Island, The Otways, Wilsons Promontory and the Yarra Valley wineries. Go hiking in the You Yangs or the Grampians. Visit the historic cities of Healesville and Castlemaine, or take in the alpine wilderness of the Snowy Mountains area.

Victoria is Australia's second most populous state. Originally inhabited by the Aboriginal people of the Kulin nation, Victoria is now home to six million people from every part of the world.



The Grampians National Park, Western Victoria.

Bendigo

Bendigo is a vibrant hub in regional Victoria. Originally the epicentre of the 1850s goldrush, it is rich in Australian history and features grand, Victorian-era architecture. Bendigo also has a strong multicultural history, with one in five of the early population emigrating from China. Now a large and modern city, it remains surrounded by native bushland. This gives it a bright yet relaxed energy and ensures a rich and focused learning experience.



Top: Sacred Heart Cathedral
Bottom: A Bendigo Tram.

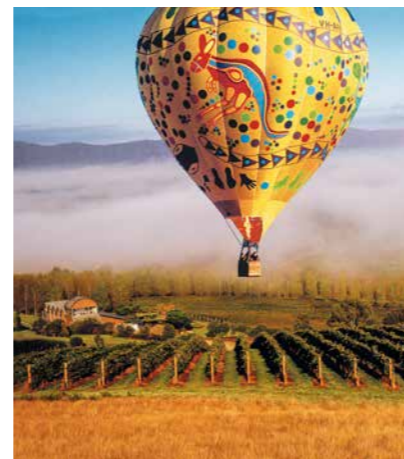

An early morning balloon ride.



Go surfing at one of Victoria's many beaches.



The Murray River near Mildura

Experiencing La Trobe



Make your time at La Trobe a memorable one.

There's more to La Trobe than just going to class and completing assignments. Get to know your fellow students, join one of the many clubs and societies, attend an event or lace up the boots and get active.

All campuses

Clubs and societies

La Trobe boasts more than 90 clubs and societies for you to join. From animal rights and archaeology, to swing dancing and board games, there's bound to be something to excite your interest.

Events

La Trobe hosts a large number of events every year to educate, entertain and inspire. From public lectures and entrepreneurship workshops to social events, there are many ways to get involved.

Sports

Join a team or take advantage of our on-campus Sports Centre, which offers a range of services to keep you fit and healthy while you study.

Melbourne Campus

Surrounded by bushland, our Melbourne Campus is one of the largest in Australia. It has a variety of cafés, sports centre, medical centre, cinema, student accommodation and a multi-level library. We are a welcoming community, with state-of-the-art research centres and our own wildlife sanctuary.

Bendigo Campus

For a taste of life in regional Australia, you can choose Bendigo as your study abroad campus.

Currently undergoing a A\$50 million upgrade, the campus will offer world-class library, technology and engineering facilities. You'll benefit from our connections to local businesses, festivals, galleries and sporting teams.

Campus life offers

- Student support services
- Library facilities
- Fitness centres
- Cafés and retail options

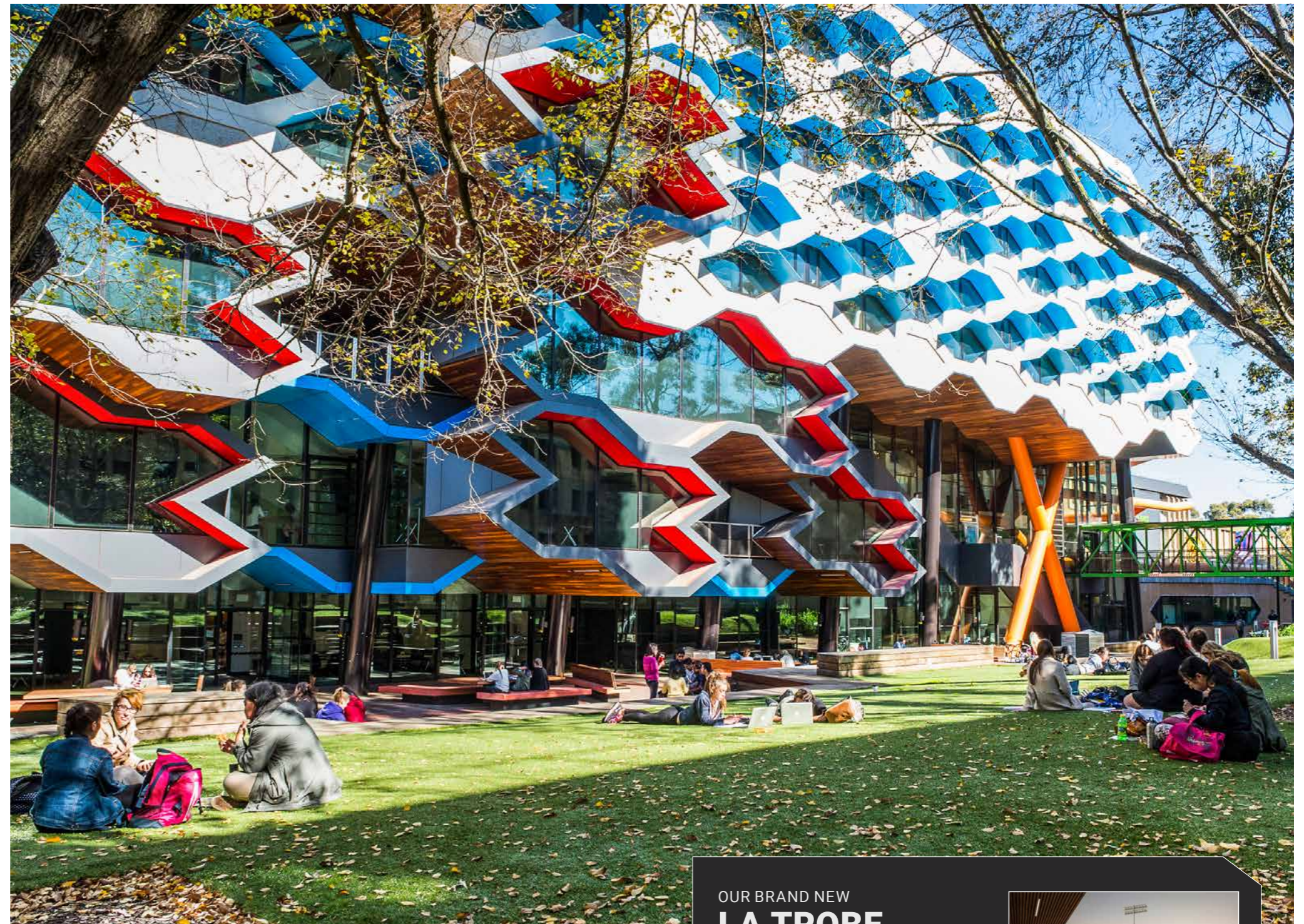

La Trobe Institute for Molecular Sciences (LIMS) Building, Melbourne.



Explore our campus wildlife reserve.



Bendigo Campus.



La Trobe has a wide range of sporting clubs.

OUR BRAND NEW
LA TROBE SPORTS PARK
 OPENS SOON

Subject areas



At La Trobe, you can customise your study plan with a wide selection of subjects offered by the College of Arts, Social Sciences and Commerce (ASSC) and the College of Science, Health and Engineering (SHE).

Arts, humanities and social sciences

- Aboriginal studies
- Anthropology
- Archaeology
- Art history
- Asian studies
- Classics and ancient history
- Creative and professional writing
- Crime, justice and legal studies
- English
- Gender, sexuality and diversity studies
- History
- Human geography
- International studies
- Latin American studies
- Linguistics
- Media studies
- Philosophy
- Politics
- Screen studies
- Sociology
- Sustainability and development
- Theatre and drama

Business and economics

- Accounting
- Agribusiness
- Economics
- Environmental management
- Event management
- Financial management
- Human resource management
- International business
- Management
- Marketing
- Sport management
- Tourism and hospitality

Creative arts

- Screen
- Theatre
- Visual arts¹
- Writing

Education

- Early childhood education
- Education studies
- Physical, health and outdoor education¹
- Primary education
- Secondary education

Engineering

- Civil engineering
- Industrial engineering

Health sciences²

- Exercise science
- Health and sustainability¹
- Health promotion
- Human nutrition
- Human physiology and anatomy
- Nursing
- Pharmacy¹
- Public health
- Social work

Information Technology

- Computer science
- Cybersecurity
- Information technology

Languages

- Chinese
- French
- Hindi
- Indonesian
- Italian
- Japanese
- Modern Greek studies
- Spanish

Law

- Law

Science

- Agricultural sciences
- Animal and veterinary biosciences
- Biochemistry
- Biological sciences
- Biomedical science
- Botany
- Chemistry
- Environmental geoscience
- Genetics
- Mathematics
- Microbiology
- Molecular biology¹
- Nanotechnology
- Pharmaceutical chemistry¹
- Physics
- Psychology
- Statistics
- Wildlife and conservation biology
- Zoology

Tuition fees

The tuition fees for the 2019 Study Abroad program per semester are shown below:

4-subject option (60 credit points): A\$9 200
3-subject option (45 credit points): A\$6 900

Tuition fees are subject to change annually.³

1. Bendigo Campus only.

2. Entry into some health sciences subjects is restricted and cannot be guaranteed.

3. 60 credit points (4 subjects) is a full-time study load at La Trobe University. If your home institution requires a 5-subject enrolment, special approval will be required by La Trobe University and additional fees will apply.



How to apply



01

Choose your course

Learn more:

latrobe.edu.au/your-subjects

02

Check the admission requirements

Make sure you meet the academic and English language requirements for your course. Find out more:

latrobe.edu.au/study-abroad

03

Apply online in 3 steps

Step 1

Access the Student Portal and register as a new user:

isisprd.latrobe.edu.au/ISIS/Portal/Login.aspx

Step 2

Access your email to retrieve your username and password.

Step 3

Log in to the Student Portal and start your online application.

04

Attach supporting documents

Complete your application by scanning and uploading the following documents to the Student Portal:

- copy of your official academic transcript (if your transcript is not in English, please also provide a certified English translation)
- evidence of your English language proficiency, if you are from a non-English speaking country
- one-page personal statement stating why you would like to study at La Trobe University as a Study Abroad student
- academic reference from your home institution
- copy of your passport ID page.

05

Accept your offer

Once your application is approved, you'll receive an email with your offer letter and a step-by-step guide on how to accept your offer, pay your tuition fees and provide any outstanding documents.

06

Apply for your student visa

Once you have accepted your offer, you will receive a Confirmation of Enrolment (CoE). This enables you to apply for an Australian student visa.

latrobe.edu.au/student-visa

Note: you can also apply to study at La Trobe via post, fax or email. Alternatively, you can deliver your application form and documentation in person at:

La Trobe University
International Admissions
Sylvia Walton Building
Plenty Road and Kingsbury Drive
Melbourne, Victoria
Australia 3086

E intapplication@latrobe.edu.au
F +61 3 9479 3660

Important dates

Semester 1, 2019

Orientation: 25 February – 1 March
Semester dates: 4 March – 27 June

Semester 2, 2019

Orientation: 22 – 26 July
Semester dates: 29 July – 21 November

You should apply to La Trobe University at least 12 weeks before Orientation to allow sufficient time for your visa application.



Accommodation and living costs



La Trobe University is more than just a place to live. You'll have memorable experiences, develop lifelong friendships and be part of a supportive, safe and social community.

Living on campus

On-campus accommodation is convenient and secure, with university classes only a short walk from your room. You'll have access to furnished bedrooms, shared kitchens and bathrooms, along with areas to study, relax and exercise.

We offer a range of catered and non-catered accommodation options at our Melbourne and Bendigo campuses.

latrobe.edu.au/on-campus

Study support

We provide our residents with free academic mentoring and support. You will have access to a textbook borrowing scheme, specialist subject tutors, workshops and more.

Health and wellbeing

Services include:

- individual counselling
- group programs and workshops
- self-help resources
- 24-hour student support hotline.

latrobe.edu.au/on-campus

Off-campus accommodation

If living on campus is not for you, we can help you find off-campus accommodation close to the University, including:

- share housing
- hostels and rooming houses
- private rental vacancies
- student apartments.

latrobe.edu.au/off-campus



Living costs

Making the decision to study overseas is exciting and life changing. Before you leave, it is important to consider the costs of living in Australia.

The below guide provides an average estimate of the costs associated with your studies, so that you can start planning.

The Department of Home Affairs recommends that you allow A\$1 690 per month for living in Australia.

	Melbourne	Bendigo
Annual living costs (A\$) including off-campus accommodation		
Establishment costs (average total cost, including bond/rent in advance, utilities connections and household items)	1 315	1 260
Books and stationery	683	683
Weekly expenses (including rent, food, household items, utilities, transport and entertainment)	547	522
Total estimate	21 730	20 735

Please note: Annual living costs will vary according to your lifestyle. Accommodation prices are based on the cheapest options available for off-campus accommodation in Victoria. Estimates are calculated for a single person, indicative only, and listed in Australian dollars (A\$).

For a more detailed list, please visit:

latrobe.edu.au/living-costs



La Trobe University acknowledges that our campuses are located on the lands of many Traditional Custodians in Victoria and New South Wales. We recognise their ongoing connection to the land and value their unique contribution to the University and wider Australian society.

La Trobe University is committed to providing opportunities for Aboriginal and Torres Strait Islander people, both as individuals and communities, through teaching and learning, research and community partnerships across all our campuses.

The wedge-tailed eagle (*Aquila audax*) is one of the world's largest and the Wurundjeri people – Traditional Owners of the land where our Melbourne campuses are located – know the wedge-tailed eagle as Bunjil, the creator spirit of the Kulin Nations.

There is a special synergy between Bunjil and the La Trobe University logo of an eagle. The symbolism and significance for both La Trobe and for Aboriginal people challenges us all to gamagoen yarrbat – to soar.

Follow us on social media

Ask a question or experience university life



Facebook
facebook.com/latrobe



Twitter
twitter.com/latrobe



La Trobe Times blog
latrobetimes.blogs.latrobe.edu.au



YouTube
youtube.com/latrobeuniversity



Instagram
instagram.com/latrobeuni



Weibo
澳大利亚乐卓博大学官方微博
weibo.com/latrobeuniaux



**Nest: a content hub
for clever thinkers**
nest.latrobe



For further enquiries

Telephone
+61 3 9479 2112

Free-call
1800 619 768 (within Australia)

Online enquiries
studyabroad@latrobe.edu.au

Disclaimer: The information contained in this publication is indicative only. While every effort is made to provide full and accurate information at the time of publication, the University does not warrant the currency, accuracy or completeness of the contents. The University reserves the right to make changes without notice, at any time in its absolute discretion, including but not limited to varying admission or assessment requirements, or varying or discontinuing any course or subject. To the extent permitted by law, the University does not accept responsibility for any loss or damage occasioned by use of any of the information contained in this publication. For course information updates, please visit: latrobe.edu.au/courses

La Trobe University is a registered provider under the Commonwealth Register of Institutions and Courses for Overseas Students (CRICOS), CRICOS Provider 00115M. Published by La Trobe University, August 2018.

latrobe.edu.au/exchange-study-abroad